



# MESA / ATLAS

Mesa & Atlas Compressors. Small sizes. Big difference.

## KEY FEATURES AND BENEFITS

- ▶ Micro and mini size
- ▶ AC & DC ranges
- ▶ Quiet
- ▶ Variable speed

### ▶ Compact:

Tecumseh has reduced the weight and the size of the rotary compressor to about a 350 ml soda can. which is one-fourth of the size of a conventional compressor.

### ▶ Dual power supply option:

Voltage ranges available from 24 to 48 VDC, and 100 to 220 VAC.

### ▶ Quiet operation:

Stable / low vibration mechanism and reduced friction cylinder components minimize noise.

### ▶ Reduced energy:

The new Micro/Mini Rotary compressors combine high efficiency motors with optimized pumping mechanisms resulting in industry leading compressor EERs.



## APPLICATIONS

Some of these applications are listed below:

- ▶ Automotive (Individual A/C Systems)
- ▶ Bus / RV Refrigerators
- ▶ Truck / Boat Refrigerators
- ▶ Truck Parking Cooler (No-Idle)
- ▶ Home Appliances
- ▶ Aircraft Cooling
- ▶ Telecommunications Cooling
- ▶ Medical





# MESA / ATLAS

Mesa & Atlas Compressors. Small sizes. Big difference.

## COMPRESSOR INFORMATION

### Capacity range\*:

- LBP: from 111 to 318 Watts
- HBP/LBP: from 111 to 556 Watts

### Refrigerant:

- R134a

### Application(s):

- LBP temperature:  
-40°C to -12.2°C
- Air conditioning temperature:  
-25°C to +20°C



Application Code Table		
Application Code	Evaporator Temperature	Rating Point
3	HBP	7.2°C
4	HBP/LBP	7.2°C / -23.3°C

Voltages Available (DC)	
	24 48
Mesa	■ ■
Atlas	■

Voltages Available (AC)	
	100 220
Mesa	■ ■

Refrigerant			
Code Table	Mesa	Atlas	
Y	R134a	■	■

Voltage Code Table	
VOLTAGE CODE	NOMINAL VOLTAGE RANGE DC
17	48 VDC
18	24 VDC
19	100 VDC
20	200 VDC

### Compressor Model Naming Convention

The Masterflux model naming convention is very simple. A sample model and the breakdown of each of the parts is shown below. Please remember that a model may have several different part numbers depending on the particular configuration.

**MESA18-0085Y3**

Family  
Voltage  
Displacement  
Application  
Refrigerant

\*LOW / FREEZER: performance rated at -23.3°C evap., 49°C cond., 27.4°C superheat, 0°C subcooling, 35°C ambient.  
HIGH / AIR CONDITIONING: performance rated at 7.2°C evap., 54.4°C cond., 11.1°C superheat, 8.3°C subcooling, 35°C ambient.

## CONTROLLER INFORMATION

Voltage range: 16-32 VDC, 42-60 VDC, 85-130 VAC, 196-299 VAC.

### Key features:

- Start and Run the compressor
- Locked-Rotor protection
- Thermal protection
- Speed control
- Power and current control
- Provide diagnostic information
- Low and high voltage shutdown

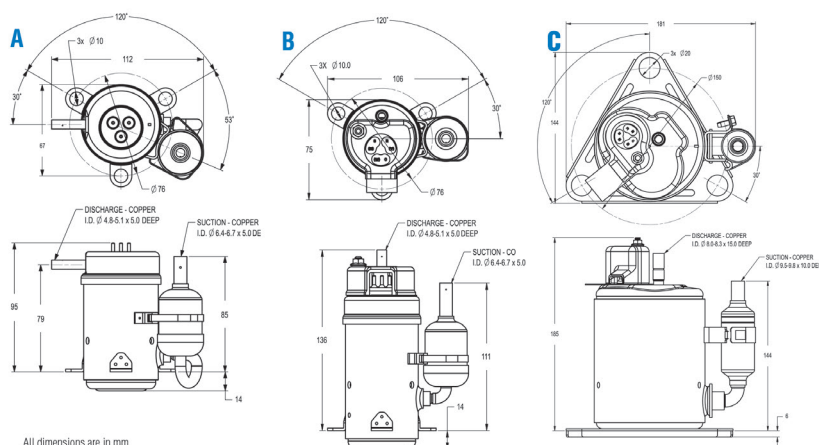

All dimensions are in mm.

For more information on products by Tecumseh, please visit our website [www.tecumseh.com](http://www.tecumseh.com)



NWD0179